

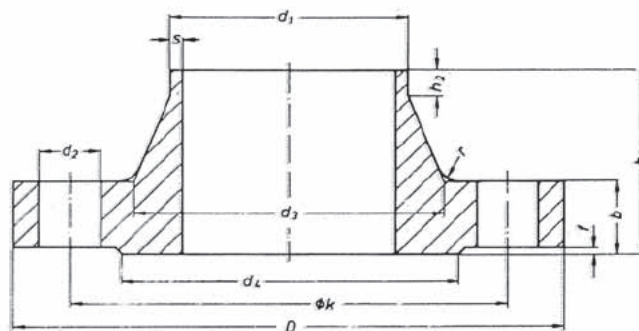

ФЛАНЦИ ЗА ЧЕЛНО ЗАВАРЯВАНЕ (ЮБКОВИ) ОТ НЕРЪЖДАЕМА СТОМАНА - 304L и 316L (PN40)

DIN 2635



Pipe		Flange				Neck Dimensions				Face Angle		Bolt Holes			
Dimension	d1		D	b	k	h1	d3	s	r	h2	d4	f	Each	Screw	d2
	ISO item 1	DIN item 2													
10	-	14	90	16	60	35	25	1.8	4	6	40	2	4	M12	14
	17.2	-													
15	-	20	95	16	65	38	30	2	4	6	45	2	4	M12	14
	21.3	-													
20	-	25	105	18	75	40	38	2.3	4	6	58	2	4	M12	14
	26.9	-													
25	-	30	115	18	85	40	42	2.6	4	6	68	2	4	M12	14
	33.7	-													
32	-	38	140	18	100	42	52	2.6	6	6	78	2	4	M16	18
	42.4	-													
40	-	44.5	150	18	110	45	60	2.6	6	7	88	3	4	M16	18
	48.3	-													
50	-	57	165	20	125	48	72	2.9	6	8	102	3	4	M16	18
	60.3	-													
65	76.1	-	185	22	145	52	90	2.9	6	10	122	3	8	M16	18
80	88.9	-	200	24	160	58	105	3.2	8	12	138	3	8	M16	18
100	-	108	235	24	190	65	128	3.6	8	12	162	3	8	M20	22
	114.3	-													
125	-	133	270	26	220	68	155	4	8	12	188	3	8	M24	26
	139.7	-													
150	-	159	300	28	250	75	182	4.5	10	12	218	3	8	M24	26
	168.3	-													
175	193.7	-	350	32	295	82	218	5.6	10	15	260	3	12	M27	30
200	219.1	-	375	34	320	88	244	6.3	10	16	285	3	12	M27	30
250	-	267	450	38	385	105	298	7.1	12	18	345	3	12	M30	33
	273	-													
300	323.9	-	515	42	450	115	362	8	12	18	410	4	16	M30	33
350	355.6	-	580	46	510	125	408	8.8	12	20	465	4	16	M33	36
	-	368													
400	406.4	-	660	50	585	135	462	11	12	20	535	4	16	M36	39
	-	419													
500	508	-	755	52	670	140	562	14.2	12	20	615	4	20	M39	42