

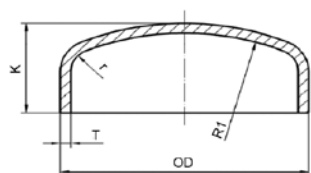

# EN Butt Weld Fittings



## End Cap

ISO, Metric  
EN 10204 3.1



OD mm	T mm	Type	K mm	r mm	R1 mm	Kg / pc		4301 4307	4404
17.20	2.00	ISO	11.5	1.3	13.2	0.090			●
21.30	2.00	ISO	14.5	1.7	17.3	0.015		●	●
25.00	2.00	Metric	12.0	2.1	21.0	0.016			●
26.90	2.00	ISO	10.5	2.3	22.9	0.015		●	●
28.00	2.00	Metric	12.0	2.4	24.0	0.022			●
30.00	2.00	Metric	12.0	2.6	26.0	0.024			●
33.70	2.00	ISO	12.5	3.0	29.7	0.023		●	●
33.70	3.00	ISO	14.5	2.8	27.7	0.035			●
38.00	2.00	Metric	15.0	3.4	34.0	0.034			●
40.00	2.00	Metric	14.0	3.6	36.0	0.033			●
42.40	2.00	ISO	17.0	3.8	38.4	0.042		●	●
42.40	3.00	ISO	18.0	3.6	36.4	0.063			●
48.30	2.00	ISO	17.0	4.4	44.3	0.050		●	●
50.80	2.00	Metric	19.0	4.7	46.8	0.055		●	●
54.00	2.00	Metric	19.0	5.0	50.0	0.058		●	●
60.30	2.00	ISO	20.0	5.6	56.3	0.076		●	●
60.30	3.00	ISO	22.0	5.4	54.3	0.115		●	●
63.50	2.00	Metric	19.0	6.0	59.5	0.078			●
70.00	2.00	Metric	21.0	6.6	66.0	0.097		●	●
76.10	2.00	ISO	27.0	7.2	72.1	0.131		●	●
76.10	3.00	ISO	29.0	7.0	70.1	0.196		●	●
84.00	2.00	Metric	23.0	8.0	80.0	0.131		●	●
88.90	2.00	ISO	29.0	8.5	84.9	0.166		●	●
88.90	3.00	ISO	29.0	8.3	82.9	0.249		●	●
101.60	2.00	Metric	25.5	9.8	97.6	0.187		●	●
101.60	3.00	Metric	27.0	9.6	95.6	0.280		●	●
104.00	2.00	Metric	24.0	10.0	100.0	0.187		●	●
106.00	3.00	Metric	25.0	10.0	100.0	0.280			●
108.00	2.00	Metric	32.0	10.4	104.0	0.246		●	●
114.30	2.00	ISO	32.0	11.0	110.3	0.246		●	●
114.30	3.00	ISO	32.0	10.8	108.3	0.369		●	●
129.00	2.00	Metric	34.0	12.5	125.0	0.314		●	●
139.70	2.00	ISO	35.0	13.6	135.7	0.372		●	●
139.70	3.00	ISO	36.0	13.4	133.7	0.565		●	●
139.70	4.00	ISO	36.0	13.2	131.7	0.709			●
154.00	2.00	Metric	41.0	15.0	150.0	0.444		●	●
156.00	3.00	Metric	42.0	15.0	150.0	0.820			●
159.00	4.00	Metric	42.0	15.1	151.0	1.150			●
168.30	2.00	ISO	40.0	16.4	164.3	0.518		●	●
168.30	3.00	ISO	43.0	16.2	162.3	0.776		●	●
204.00	2.00	Metric	50.0	20.0	200.0	0.754		●	●
206.00	3.00	Metric	50.0	20.0	200.0	1.130			●
219.10	2.00	ISO	50.0	21.5	215.1	0.849		●	●
219.10	3.00	ISO	51.0	21.3	213.1	1.274		●	●
254.00	2.00	Metric	55.0	25.0	250.0	1.078		●	●
256.00	3.00	Metric	55.0	25.0	250.0	1.620			●
273.00	2.00	ISO	63.0	26.9	269.0	1.310		●	●

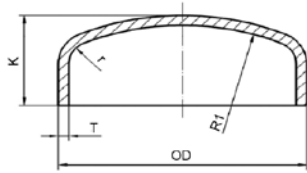

## End Cap

ISO, Metric  
EN 10204 3.1



OD mm	T mm	Type	K mm	r mm	R1 mm	Kg / pc		4301 4307	4404
273.00	3.00	ISO	62.0	26.7	267.0	1.966		●	●
273.00	4.00	ISO	62.0	26.5	265.0	3.621			●
304.00	2.00	Metric	68.0	30.0	300.0	1.646		●	●
306.00	3.00	Metric	70.0	30.0	300.0	2.470		●	●
323.90	2.00	ISO	72.0	32.0	319.9	1.814		●	●
323.90	3.00	ISO	72.0	31.8	317.9	2.720		●	●
323.90	4.00	ISO	72.0	31.6	315.9	3.627			●
355.60	3.00	ISO	89.0	35.0	349.6	3.516		●	●
355.60	4.00	ISO	89.0	34.8	347.6	5.315			●
406.40	3.00	ISO	98.0	40.0	400.4	4.523		●	●
457.20	3.00	ISO	107.0	45.1	451.2	5.494		●	●
508.00	3.00	ISO	120.0	50.2	502.0	6.558		●	●
609.60	3.00	ISO	140.0	60.4	603.6	9.232		●	●

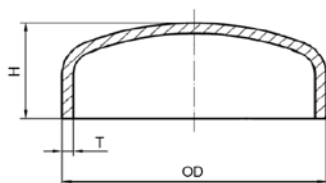

## End Cap

ASTM-A 403 ASME B16.9  
EN 10204 3.1



OD mm	T mm	INCH-GAS-SCH	H mm	Kg / pc		304/L	316/L
21.34	2.11	1/2" SCH 10S	25.4	0.050		●	●
21.34	2.77	1/2" SCH 40S	25.4	0.070		●	●
26.67	2.11	3/4" SCH 10S	25.4	0.060		●	●
26.67	2.87	3/4" SCH 40S	25.4	0.080		●	●
33.40	2.77	1" SCH 10S	38.1	0.075		●	●
33.40	3.38	1" SCH 40S	38.1	0.090		●	●
42.16	2.77	1.1/4" SCH 10S	38.1	0.100		●	●
42.16	3.56	1.1/4" SCH 40S	38.1	0.130		●	●
48.26	2.77	1.1/2" SCH 10S	38.1	0.130		●	●
48.26	3.68	1.1/2" SCH 40S	38.1	0.170		●	●
60.33	2.77	2" SCH 10S	38.1	0.190		●	●
60.33	3.91	2" SCH 40S	38.1	0.260		●	●
73.03	3.05	2.1/2" SCH 10S	38.1	0.240		●	●
73.03	5.16	2.1/2" SCH 40S	38.1	0.410		●	●
88.90	3.05	3" SCH 10S	50.8	0.370		●	●
88.90	5.49	3" SCH 40S	50.8	0.680		●	●
114.30	3.05	4" SCH 10S	63.5	0.570		●	●
114.30	6.02	4" SCH 40S	63.5	1.130		●	●
141.30	3.40	5" SCH 10S	76.2	1.100		●	●
141.30	6.55	5" SCH 40S	76.2	2.120		●	●
168.28	3.40	6" SCH 10S	88.9	1.410		●	●
168.28	7.11	6" SCH 40S	88.9	2.950		●	●
219.08	3.76	8" SCH 10S	101.6	2.470		●	●
219.08	12.70	8" SCH 40S	101.6	7.800		●	●
273.05	4.19	10" SCH 10S	127.0	4.510		●	●
273.05	9.27	10" SCH 40S	127.0	10.000		●	●
323.85	4.57	12" SCH 10S	152.4	6.670		●	●
323.85	9.53	12" SCH 40S	152.4	13.900		●	●
355.60	4.78	14" SCH 10S	165.1	8.160		●	●
355.60	9.53	14" SCH 40S	165.1	15.900		●	●
406.40	4.19	16" SCH 10S	177.8	14.510		●	●
406.40	4.19	16" SCH 40S	177.8	20.000		●	●